

Application instructions



1

Use the right tools!



2

On 1 car there can be different corrugations: the application technique will be the same. Always start in the deepest part first!



3

Clean the surface, focus on the critical areas!



4

Apply the material using firm squeegee strokes. Fix the edges of the corrugation (do not stretch!)

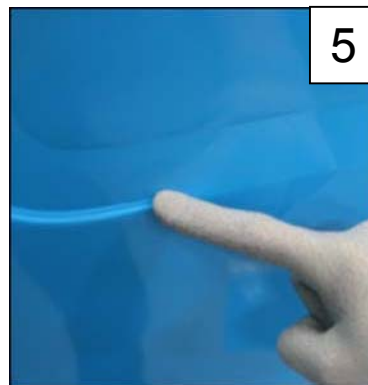

5

First 1 side (make use of a wet glove).

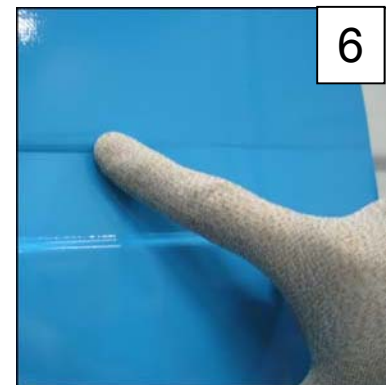

6

Then the other side.

Note: These application instructions have been made specifically for the application of printed MPI(A) 1005 or MPI(A) 1900 overlaminated using the Avery DOL 1030 3D-Laminate. For additional information please check appropriate datasheets and technical bulletins 5.3 and 5.29, which can be found on our website: www.europe.averygraphics.com .



7

Heat the material up to 45-55°C and stretch the material in the corrugation:
DEEPEST PART FIRST!



8

Then, at the same temperatures, repeat for the inner part of the corrugation.



9

Fix the material in the remaining part of the corrugation.



10

Remove small air bubbles first (if present), and then reheat the stretched areas until 80-90°C.



11

DONE !